

PRODUCT APPLICATION	FUNCTION	MATERIAL	DIM A (MM)	DIM B (MM)	DIM A (INCHES)	DIM B (INCHES)	PART NUMBER	DESCRIPTION
150 Series	Panel to Frame	Nylon	37	20	1 7/16	13/16	103506	DOG NYL BLK A37-B20 KIT
250 French	French Break	Nylon	41	18	1 5/8	11/16	108634	DOG NYL BLK A41-B18 KIT
250 French	French Break	Stainless Steel	41	18	1 5/8	11/16	107208	DOG 316 POL A41-B18 KIT
250 Series	Panel to Frame	Nylon	41	32	1 5/8	1 1/4	103508	DOG NYL BLK A41-B32 KIT
250 Series	Panel to Frame	Stainless Steel	41	32	1 5/8	1 1/4	108518	DOG 316 POL A41-B32 KIT
200 Series	Panel to Frame	Nylon	43	19	1 11/16	3/4	103507	DOG NYL BLK A43-B19 KIT
200 Series	Panel to Frame (Locking)	Nylon	43	19	1 11/16	3/4	108638	DOG NYL BLK A43-B19 LCK KIT
200 Series	Panel to Frame (Locking)	Stainless Steel	43	19	1 11/16	3/4	108637	DOG 316 POL A43-B19 KIT
200 Series	Panel to Frame (Locking)	Stainless Steel	43	19	1 11/16	3/4	108639	DOG 316 POL A43-B19 LCK KIT
575 French	French Break	Nylon	48	11	1 7/8	7/16	108623	DOG NYL BLK A48-B11 KIT
575-French	French Break	Stainless Steel	48	11	1 7/8	7/16	108548	DOG 316 POL A48-B11 KIT
575 Series	Panel to Frame	Nylon	48	32	1 7/8	1 1/4	108517	DOG NYL BLK A48-B32 KIT
575 Series	Panel to Frame	Stainless Steel	48	32	1 7/8	1 1/4	108519	DOG 316 POL A48-B32 KIT

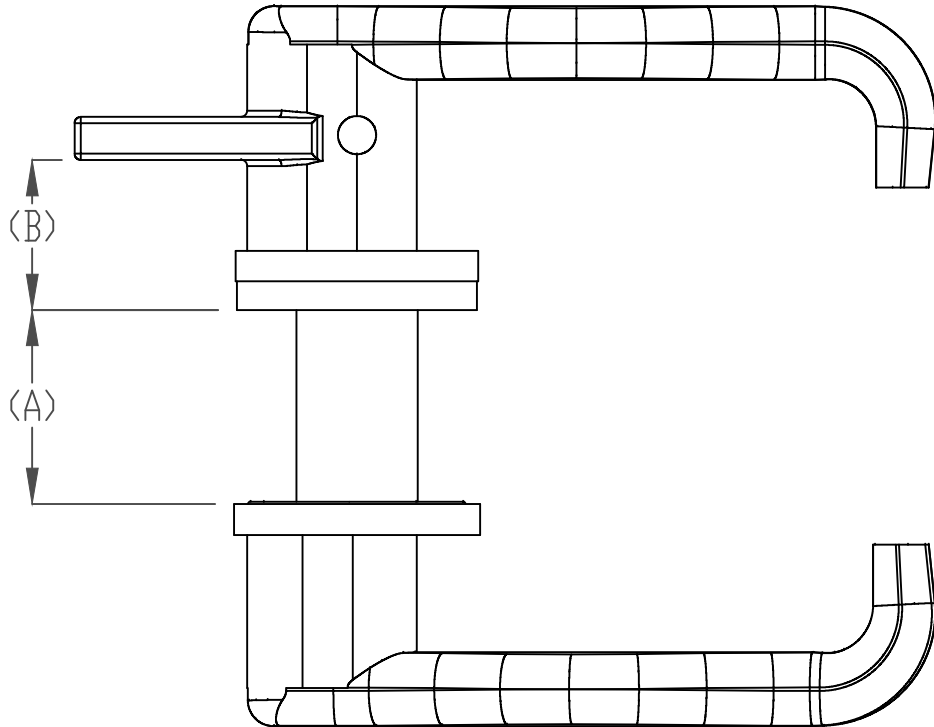

REVISIONS

REV.	DESCRIPTION	BY	DATE

GENERAL NOTES
1. REMOVE ALL BURRS AND BREAK SHARP EDGES AND CORNERS .75mm (.03in) MAX.

UNLESS OTHERWISE SPECIFIED, DIMENSIONS ARE IN MILLIMETERS. TOLERANCES FOR ROUGH AND CLEAR OPENINGS ARE ±.3mm (.0125"). ALL OTHERS ARE:

	X	.X	.XX	ANGLES
METRIC	±.25	±.0	±.25	±.2°
IMPERIAL	.X	.XX	.XXX	±.2°

DWG CODE: _____ CAGE CODE: _____



© COPYRIGHT 2018 ADVANTEC. ALL RIGHTS RESERVED. THIS DOCUMENT IS THE PROPERTY OF ADVANTEC. IT IS TO BE USED ONLY FOR THE PURPOSES SPECIFIED HEREIN. IT IS NOT TO BE REPRODUCED OR TRANSMITTED IN ANY FORM OR BY ANY MEANS, ELECTRONIC OR MECHANICAL, WITHOUT PERMISSION IN WRITING FROM ADVANTEC. DRAWINGS AND PARTS ARE NOT TO BE RETURNED UPON REQUEST.

DWG TITLE
STANDARD DOGS

SCALE	DRAWN	DATE	CHECKED	DATE	SHEET	REV
1:1	DS	2018-01-26			1	0
DWG NO					1	0